

3534 W43 Avenue,
Vancouver

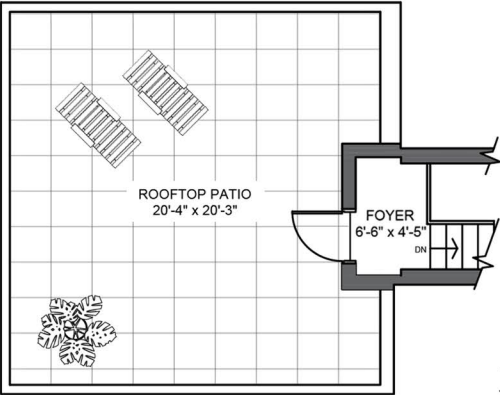

*FLOOR AREA	(SQFT.)	As Per Strata Plan
MAIN FLOOR	933	866
LOWER FLOOR	1,027	1,012
UPPER FOYER	52	59
LIVING AREA	2,012	1,937
ROOFTOP PATIO	400	
GARAGE	212	
COV. PORCH	148	
LOWER PATIO	67	
TOTAL OTHERS	827	

